



ROCKLAND COUNTY RECYCLING CENTER

The Rockland County Solid Waste Management Authority's Recycling Center was constructed in 1998 to provide a local solution for processing recyclable materials.

Recyclables generated by the community are sorted, consolidated and sold to re-manufacturing facilities to be made back into new products.

Your recycling efforts help conserve natural resources, save landfill space and reduce waste disposal costs. Your municipality receives a rebate for every ton recycled. Keep up the good work Rockland!



TIP FLOOR



SORT LINES



BALED MATERIALS



HOME RECYCLING GUIDE

Rockland County
Solid Waste Management Authority

420 Torne Valley Road • PO Box 1217 • Hillburn, NY 10931

Phone: 845-753-2200 • Fax: 845-753-2281

STAY INFORMED

Visit: rocklandrecycles.com

Download: Recycle Coach App

Follow: @GreenUpRockland

Like: GreenUpRockland

Howard T. Phillips, Jr., *Chairman*
Anna Roppolo, *Executive Director*





ROCKLAND RECYCLES

Sorting your paper, cardboard and other recyclables is quick and easy. Just focus on tossing all mixed paper into one bin and plastic, glass and metal into another. Please **EMPTY** and **RINSE** all containers and **flatten** and **break down** cardboard boxes.



Corrugated Cardboard
(Boxes, paper bags, & drink holders)



File Folders and Office Paper
(All colors)



Plastic Bottles, Jugs, Tubs, and Lids
(Empty kitchen, laundry, & bath containers)



Large Rigid Plastics
(Laundry baskets & 5-gallon pails)



Newspaper
(All sections & inserts)



Mail and Greeting Cards
(Junk mail, & envelopes)



Glass Bottles and Jars
(Empty food & beverage bottles & jars)



Aluminum and Steel Cans
(Foil & empty food & beverage cans)

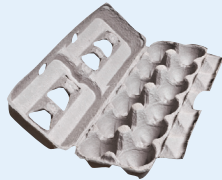

Egg Cartons



Cartons
(Milk, juice, & food)



MIXED PAPER



MIXED CONTAINERS

TIPS FOR GREAT RECYCLING!

- ✓ Place shredded paper in paper bags
- ✓ Cardboard is flattened & broken down
- ✓ All containers are empty, rinsed, & dry
- ✓ Keep it loose! Don't bag up your recyclables

The items listed below **DON'T** belong in your recycling bin



PLASTIC BAGS



DISPOSABLE ITEMS





HAZARDOUS & ELECTRONIC WASTE



SHARPS WASTE

 **INSTEAD:** Recycle your bags at a participating grocery or retail store.

 **INSTEAD:** Throw all disposable items in the trash.

 **INSTEAD:** Bring items to the Household Hazardous Waste Facility in Pomona.

 **INSTEAD:** Find safe & secure disposal information at www.rocklandgov.com.